

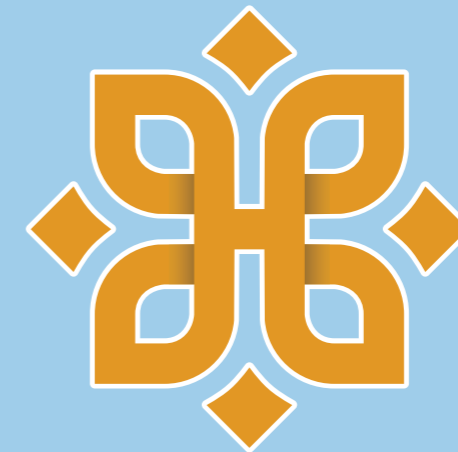

HAMPTON AVENUE
STUDIO LOFT
@ Manhattan District

BOULEVARD UTAMA GADING SERPONG TERKONEKSI KE BSD MARET 2024



HAMPTON AVENUE
STUDIO LOFT
@ Manhattan District

LEGEND

- Residential**
 - Atlanta Village
 - Arcadia Village
 - Virginia Village
 - Trimezia
 - Magnolia Village
 - Bellano Village
 - Montana Village
 - Omaha Village
 - The Lavender
 - Amalfi Village
 - Alicante
 - San Lorenzo
 - Menteng Village
 - Menaggio Village
 - Fiordini
 - Nara Village
 - Milano Village
 - Latigo Village
 - Malibu Village
 - Amarillo Village
 - Pasadena Grand Residences
 - Sektor 7A
 - Bohemia Village
 - Sektor 7C
- Commercial**
 - Solvang Arcade
 - Ruko Blitz
 - Ruko Glaze
 - Ruko Vienna
 - Pasar Modern Paramount
 - L'Agricola
 - Pisa Grande
 - Sorrento Junction
 - Sorrento Square
 - Ruko Alicante
 - Verona Junction
 - Ruko Mendrisio
 - Maggiore Square
 - Ruko Bavaria
 - New Santa Monica
 - New Santa Anna
- Medical Center**
 - Bethsaida Hospital
 - Bethsaida Clinic
 - Mitra Keluarga Hospital
 - St. Carolus Hospital
 - EMC Healthcare
- Hotels**
 - Atria Hotel
 - Vega Hotel
 - Fame Hotel
 - JHL Solitaire
 - Episode Hotel
 - Ibis Hotel
 - Qubika Boutique Hotel
 - Mercure Hotel
 - Hotel Santika Premiere
- Mall & Eatery**
 - BEZ Walk
 - Supermal Karawaci
 - IKEA
 - Summarecon Mall Serpong
 - Qbig
 - ICE BSD
 - AEON
 - Living World
 - Mall @ Alam Sutera
- Educational Institutions**
 - Matana University
 - Universitas Pelita Harapan
 - Sekolah Tarakanita
 - Sekolah Pahoa
 - Syafana Islamic School
 - Binus University
 - Universitas Multimedia Nusantara
 - Multimedia Nusantara Polytechnic
 - Pradita University
 - Universitas Prasetya Mulya
 - Sekolah Penabur
 - Stella Maris International School
- Golf Course**
 - Gading Raya Padang Golf & Club
 - Imperial Klub Golf
 - Damai Indah Golf
- Airport**
 - Soekarno-Hatta International Airport
- Siloam Hospitals Kelapa Dua**
 - Eka Hospital



PARAMOUNT PLAZA
Jl. Boulevard Raya Gading Serpong Kav. 1
Gading Serpong, Tangerang - 15810

(021) 5420-0999 | **0811-1987-999**
paramount-land.com



PARAMOUNT LAND
Building homes and people with heart

Disclaimer: Segala daya upaya telah dilakukan dalam mempersiapkan materi promosi ini. Namun demikian, pihak pengembang, PT Paramount Enterprise International beserta seluruh agennya mengingatkan bahwa setiap penyataan, informasi maupun data dapat mengalami perubahan sejalan dengan proses perencanaan yang berkembang. Semua ilustrasi / artikel impression adalah semata hasil kerajinan dari rencana arsitektur ke dalam bentuk gambar atau fotografi yang merupakan hasil rekaan dengan menggunakan model / contoh.

DENAH TIPE STUDIO LOFT

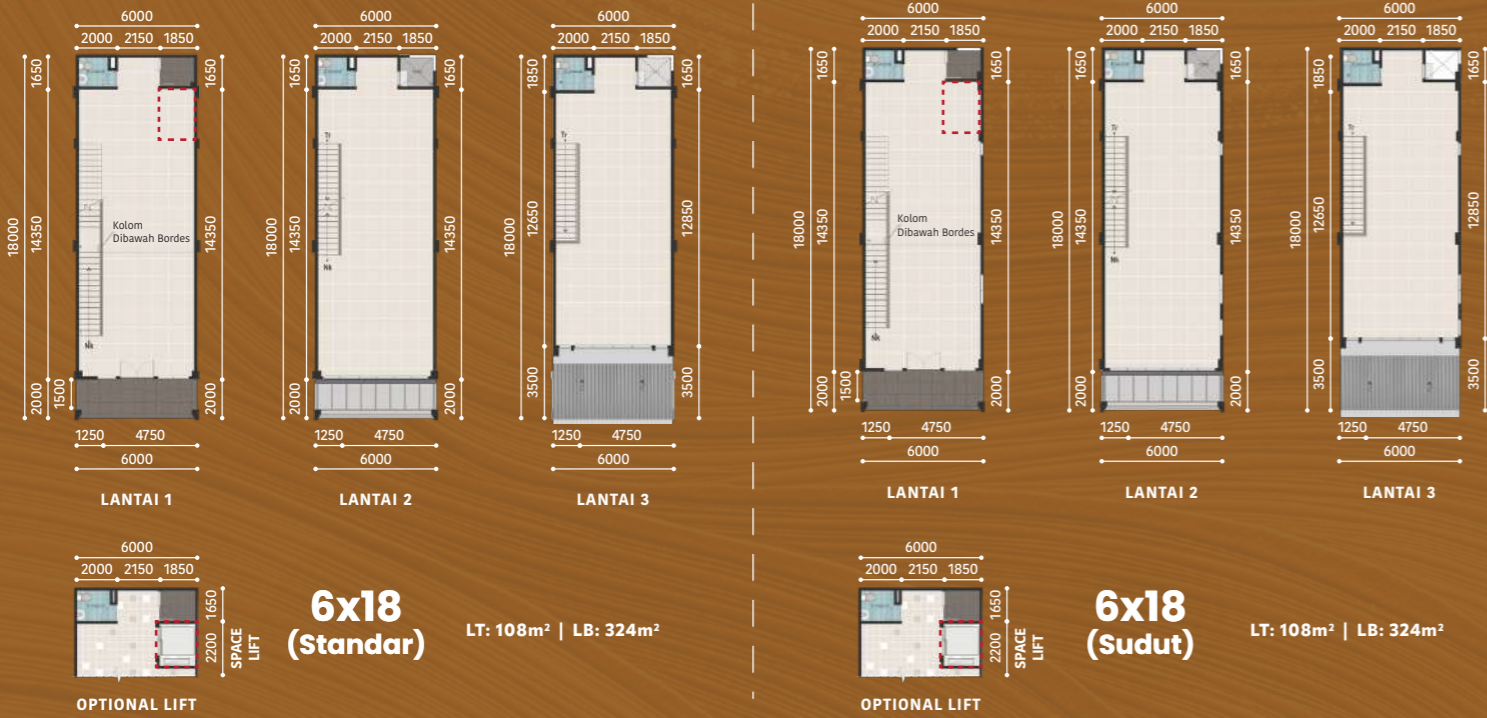

TAMPAK DEPAN STUDIO LOFT



POTONGAN STUDIO LOFT



SPESIFIKASI STUDIO LOFT

- Pondasi**: Tiang pancang (mini pile)
 - Struktur kolom, balok, dak, sloop, ring balok, tangga**: Beton bertulang
 - Rangka atap**: Rangka baja ringan (zincalium)
 - Penutup atap**: Atap metal (zincalium), Atap dak beton (bagian belakang untuk talang & toren)
 - Lantai utama**: Homogenous tile 80x80
 - Lantai teras**: Homogenous tile 60x60 anti slip
 - Lantai KM/WC**: Homogenous tile 60x60 anti slip
 - Dinding KM/WC**: Homogenous 60x60
 - Dinding dalam**: Bata ringan diplester + aci fin acrylic emulsion paint
 - Dinding luar**: Bata ringan diplester + aci fin weather resistant paint
 - Plafond dalam**: Gypsumboard
 - Plafond luar & Toilet**: Gypsum water resistant
 - Sanitary**: Toto
 - Pintu utama**: Kaca tempered frameless
 - Pintu/Jendela lainnya**: Kaca clear + frame aluminium fin powder coating
 - Pintu KM/WC**: Panel dan kusen UPVC
 - Pantry**: Disediakan instalasi air bersih dan air kotor exc. sink & meja dapur
 - Railing tangga**: Besi hollow + besi plat + handrail kayu
 - Ornamen facade**: Decorative panel
 - Canopy Teras Depan**: Kaca Laminated 5+5, rangka baja finish acp dan hollow
 - Canopy Drop Off Area**: Atap metal (Zincalium), Rangka Baja, lisplank ACP + Plafond PVC Linear
 - Lift (Opsional)**: Kapasitas maksimal 450 Kg
- INSTALASI**
- Listrik**: Suplai PLN daya 16.500 VA
 - Telepon**: Instalasi fiber optic
 - Air bersih**: Suplai Perumdam + Toren 1.000L
 - Air kotor**: Septictank biofil 2.000L

KELENGKAPAN STANDAR STUDIO LOFT



SITEPLAN

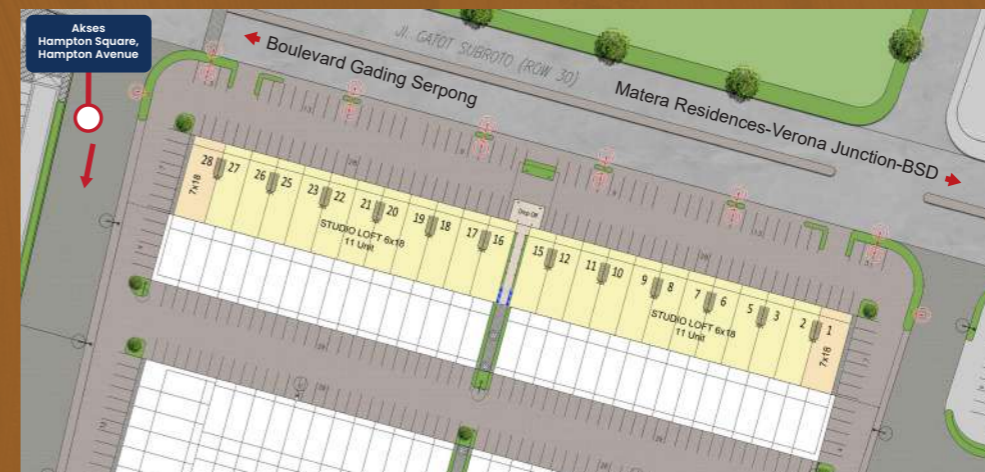

- Tipe Studio Loft 6x18
- Tipe Studio Loft 7x18

